

HOTEL
RAJPUTANA SHERATON

J D A

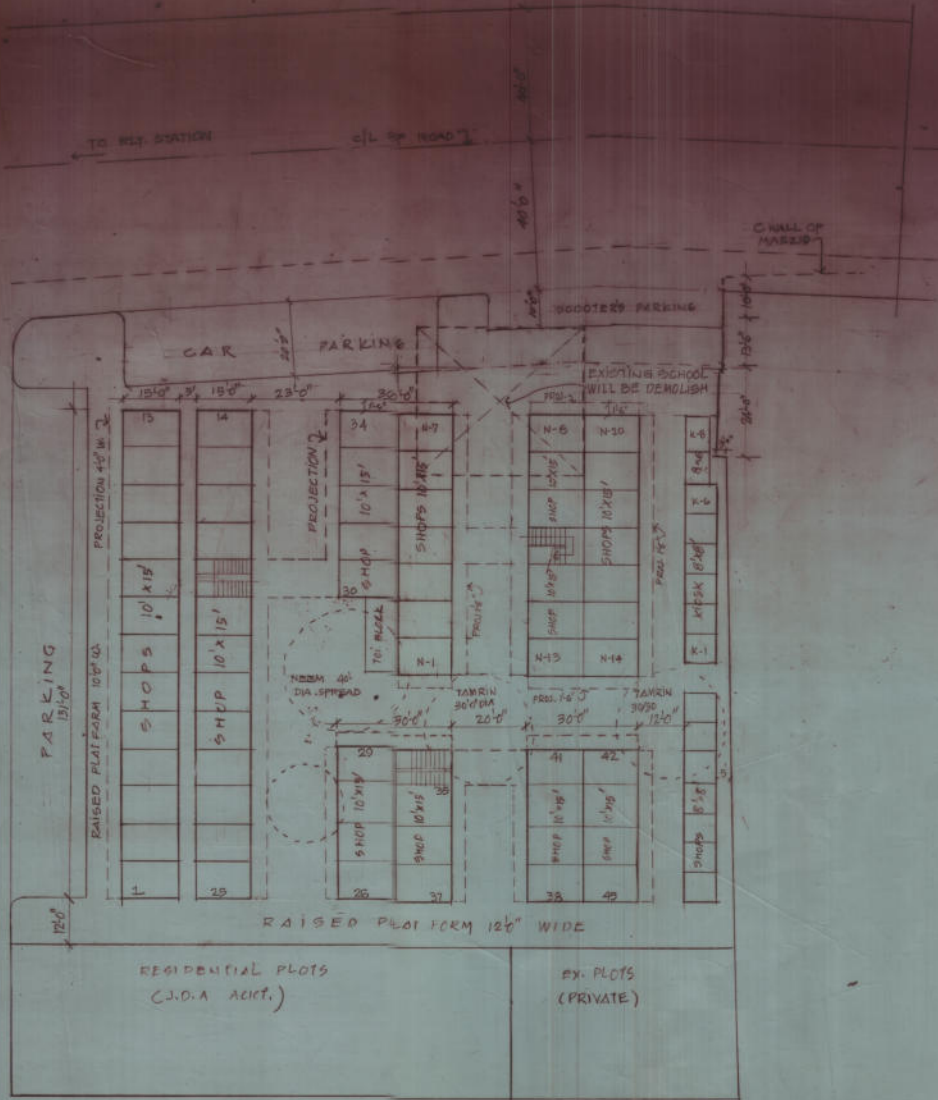

REFERENCE:-

DETAIL OF PROPOSED SHOPS/KIOSK (NEW)

- 1. SHOPS 10'-0" x 15'-0" = 150.00 SQ. FT. (114 MS) = 30 NOS
- 2. KIOSKS 8'-0" x 6'-0" = 48.00 " (314 MS) = 6 NOS
- 3. KIOSKS 8'-0" x 6'-0" = 48.00 " (144 MS) = 2 NOS

DETAIL OF EXISTING SHOPS/KIOSK (NEW)

- 1. SHOPS 10'-0" x 15'-0" = 150.00 SQ. FT. (114 MS) = 48 NOS
- 2. KIOSKS 8'-0" x 6'-0" = 48.00 " (114 MS) = 7 NOS

NOTE:-

IN BLOCK OF 10X15 FT. SHOPS PROVISION FOR STAIR CASE HAS BEEN PROVIDED SO THAT ROOF RIGHTS OF FIRST FLOOR BE RETAINED BY J.D.A.
THIS DRAWING SUPERSEED TO DRG NO C/LP/JDA/91/5

THIS DRAWING HAS BEEN APPROVED IN P.R.C. MEETING 9/2000 DATED 31-08-2000

Quisling
J.S. (P.R.C.)
J.D.A. JAIPUR

REVISED LAYOUT PLAN OF
FATEH SINGH KI DHARAM SHALA JAIPUR

DEALT BY	DRG NR C/LP/JDA/2000/1E	ISSUED ON
RAJESH,	SCALE:- 1" INCH = 20'0" FEET	14-3-2000

A.T.P. (PROJ) J.D.A. JAIPUR	Z.E. ZONE, A-2	D.C. 12/9/2000 ZONE A-2
<i>Quisling</i> A.T.P. (PROJ) J.D.A. JAIPUR	<i>Quisling</i> D.T.P. (PROJ) J.D.A. JAIPUR	

21 0 A D 25'0" WIDE