

# BANI PARK EXTENSION SCHEME (NARI KA NAKA)

NOTE: PLAN REDUCED IN SCALE OF 1:500 FROM THE ORIGINAL PLAN.

COMPARED BY: *Mr. G. S. Jaiswal*  
 ASSIST. ENGINEER  
 J.D.A. JAIPUR

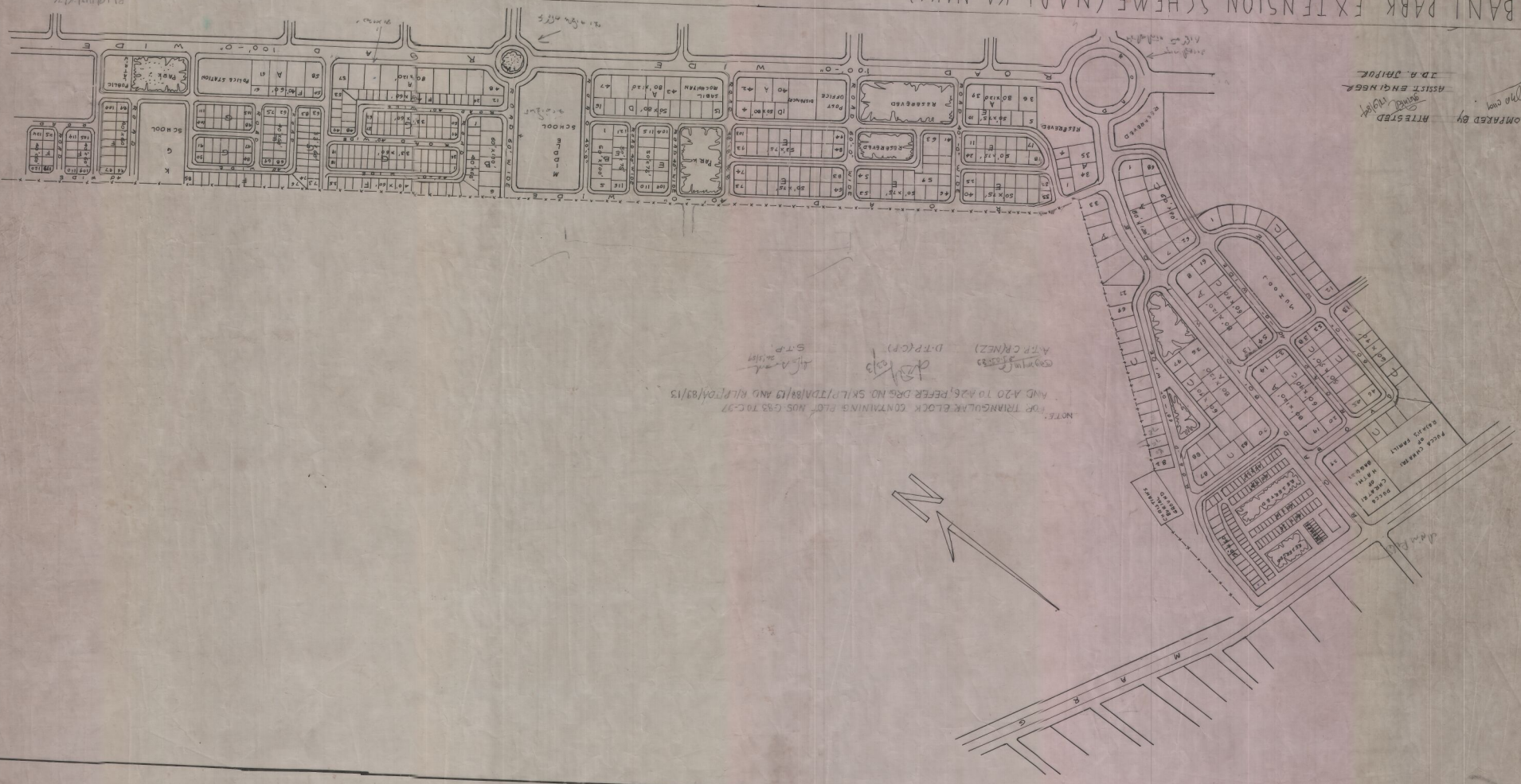

NOTE: FOR TRIANGULAR BLOCK CONTAINING PLOT NOS C-8 TO C-97 AND A-20 TO A-26, REFER DRS. NO. SLP/ITD/18/13 AND KLP/10/13/13  
 DTP (CP) *[Signature]*  
 APPROVED *[Signature]*  
 S.P. *[Signature]*

TRACED BY: S. C. SHARMA  
 S. V. KUMAR  
 S. T. JAIN  
 S. T. JAIPUR  
 CHIEF TOWN PLANNING & ADMINISTRATION OFFICER  
 J.D.A. JAIPUR

SCALE 1:500 X 0.914